

# **A Flicker of Light on a Christmas Night**

## **Technical Information**

**(August 2006 – Please destroy all previous versions)**

### **Stage Diagram and Props**

- 1) A stage diagram is enclosed. (The actual placement of the instruments need not replicate the diagram but is at the discretion of the orchestra.) Twelve feet (12') are required for the actors between the podium and the front of the stage.
- 2) - Platypus Theatre will provide the fireplace.
  - The orchestra must provide the following:
    - Christmas Tree (5 feet tall)
    - Rocking chair,
    - Ottoman (large enough for two children to sit on)
    - Cushion large enough for a child to sit on on the floor
    - Area rug approximately six feet by ten feet (6' X10')
    - SR bench. This should be a simple, wooden bench like one might find at a bus stop or in a park although it need only be big enough for one person to sit on. (See stage diagram)

### **Lighting Requirements**

There are 45 lighting cues that need to be programmed by the facility's lighting director and the company technical director prior to the dress rehearsal. Programming of cues can be done in one and a half hours with an experienced board operator and a computerized board if lights have been hung and focused in advance based on the following information.

#### **Types of lighting required:**

- 1) Standard concert washes to light the orchestra without lighting the acting areas. (Colors are suggestions, close alternatives are fine)
  - A warm amber (R04) or pink (R35)
  - Blue (R81)
  - Green (R86)
- 2) Area 1 (see stage diagram) A warm light to look like evening in a middle-class living room.
- 3) Area 2 (see stage diagram) – Warm amber or pink isolating the area on SL.
- 4) Area 2 – Green special for “Grinch” soloist(s)
- 5) Special 1 (see stage diagram) – A small pool of light on the wooden bench SR. Like the light from a street lamp.
- 6) Specials (ETC lights) for pin-prick star gobos. (Gobos supplied by Platypus Theatre)
- 7) Music stand lights. (Controllable from the booth)
- 8) Four outlets (separate circuits) on stage to plug fireplace and Christmas tree lights into. (Controllable from the booth)
- 9) Conductor Special
- 10) All lights (including music stand lights) need to be wired so that a total stage black-out is possible.

### **Sound Requirements**

- 1) Four wireless Lavalier microphones (clip-on or small over-the-ear type, NOT Madonna-style head-sets), four microphones on stands for carolers and sound system. (Must be supplied by the orchestra)
- 2) Monitor for conductor.

3) Two Monitors DS and mics on oboe and clarinet.

4) Monitor for carolers DS of Area 2

**Please refer any technical questions to Wendy Rockburn. Phone: (613) 834-5497  
email: [wendy@platypustheatre.com](mailto:wendy@platypustheatre.com) • website: [www.platypustheatre.com](http://www.platypustheatre.com)**

**N.B.** Placement of specific instruments is unimportant and is at the discretion of the orchestra

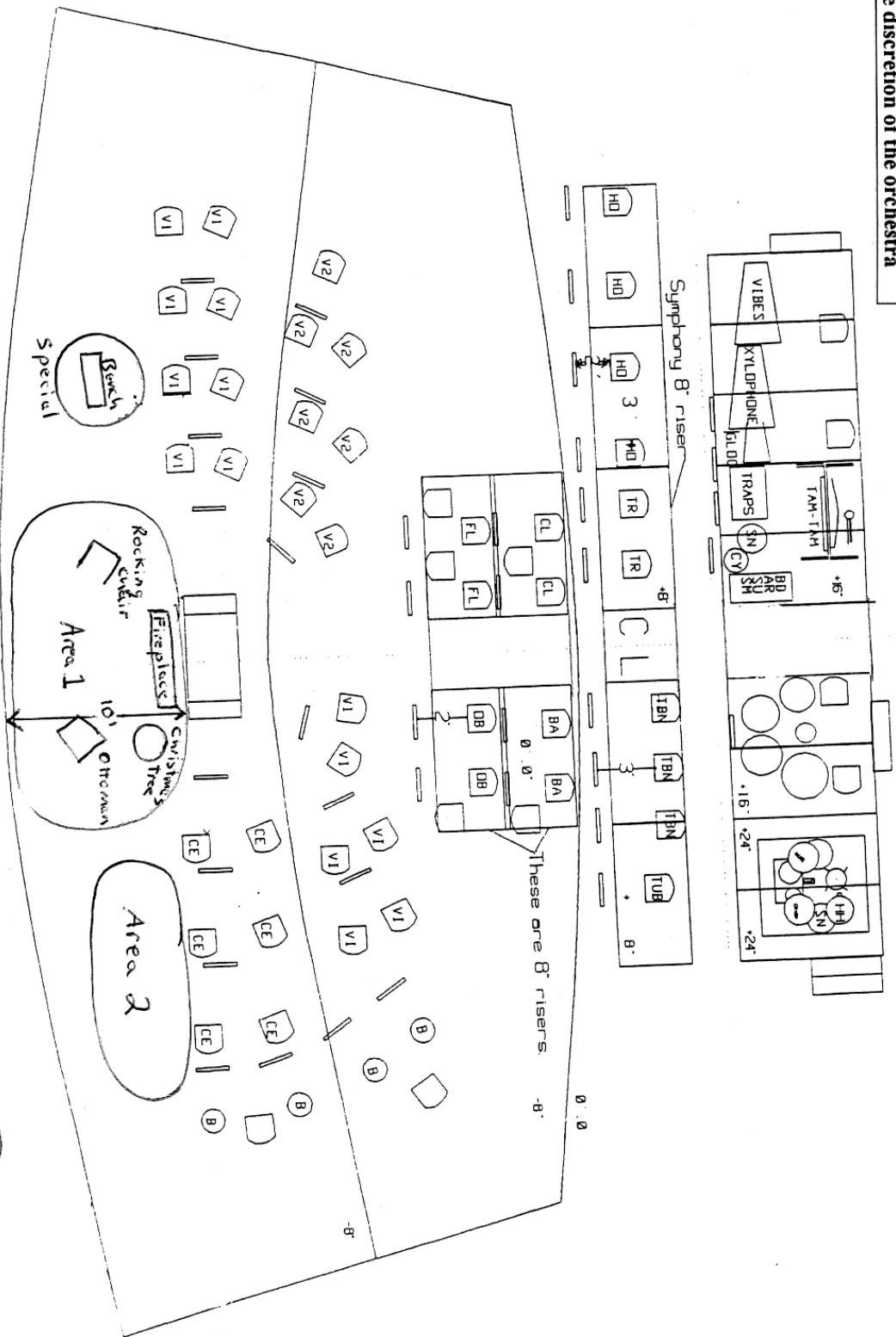

"A Flicker of Light on a Christmas Night"