

How the Gimquat Found Her Song

Technical Information

(May 2009 - Please destroy all previous versions)

A **video** of the production is supplied by Platypus Theatre. It is sent in the box of orchestra parts. Viewing of this video is very helpful to the technical crew in preparing for the production.

Stage Diagram and Props

- 1) A stage diagram is enclosed. (The actual placement of the instruments need not replicate the diagram but is at the discretion of the orchestra.)
- 2) Placing the woodwinds, brass and percussion on risers is highly desirable so that audience can see individual musicians.
- 3) The riser at the back of the orchestra and the walk-way down the center (2 feet wide minimum) are essential.
- 4) Twelve feet (12') are required for the actors between the podium and the front of the stage.
- 5) The two small skirted, sturdy, backless benches (long enough for two people to sit on) are essential and must be supplied by the orchestra.
- 6) The L shaped flat is supplied by Platypus Theatre.
- 7) Small prop table stage right.

Lighting Requirements

There are approximately 35 lighting cues that need to be programmed by the facility's lighting director and the company's technical director prior to the dress rehearsal. Programming of cues can be done in 1.5 hours with an experienced board operator and a computerized board if lights have been hung and focused in advance based on the following information.

Types of lighting required: (Colors are suggestions, close alternatives are fine)

- 1) Standard concert wash - A warm amber (R04) or pink (R35). If possible, should include apron where the actors perform.
- 2) Apron wash:
 - a) This must cover the area across the stage in front of the podium where the actors perform.
 - b) Wash needs to be a pale amber (R02).
 - c) The wash needs to be divided into 5 area specials. (See stage diagram)
- 3) Blue wash on orchestra or back wall (R81)

- 4) Green wash on orchestra or back wall (R86)
- 5) Amber wash on orchestra or back wall (R02)
- 6) Red wash on orchestra or back wall
- 7) Bright pink wash on orchestra or back wall
- 8) A programmed colour chase on the back wall to simulate time travel.
- 9) A different colour chase for "Rap" sequence.
- 10) Special on riser at back of orchestra (area 6 on diagram).
- 11) 10 (ten) lamps available for gobo specials. (Gobos supplied by Platypus Theatre)
- 12) Music stand lights.
- 13) All lights (including music stand lights) need to be wired so that a total stage black-out is possible.
- 14) Conductor Special

Sound Requirements

- 1) Two clip-on or over-the-ear inconspicuous wireless microphones. (Must be provided by orchestra)
- 2) Small mixing console, speakers suitable to the performance space.
- 3) Monitor for conductor and for drum set player.
- 4) Technician to operate sound board.

Please refer any technical questions to Peter Duschenes

phone: (613) 792-1250

email: peterduschenes@sympatico.ca • website: www.platypustheatre.com

"HOW THE GIMQUAT FOUND HER SONG"

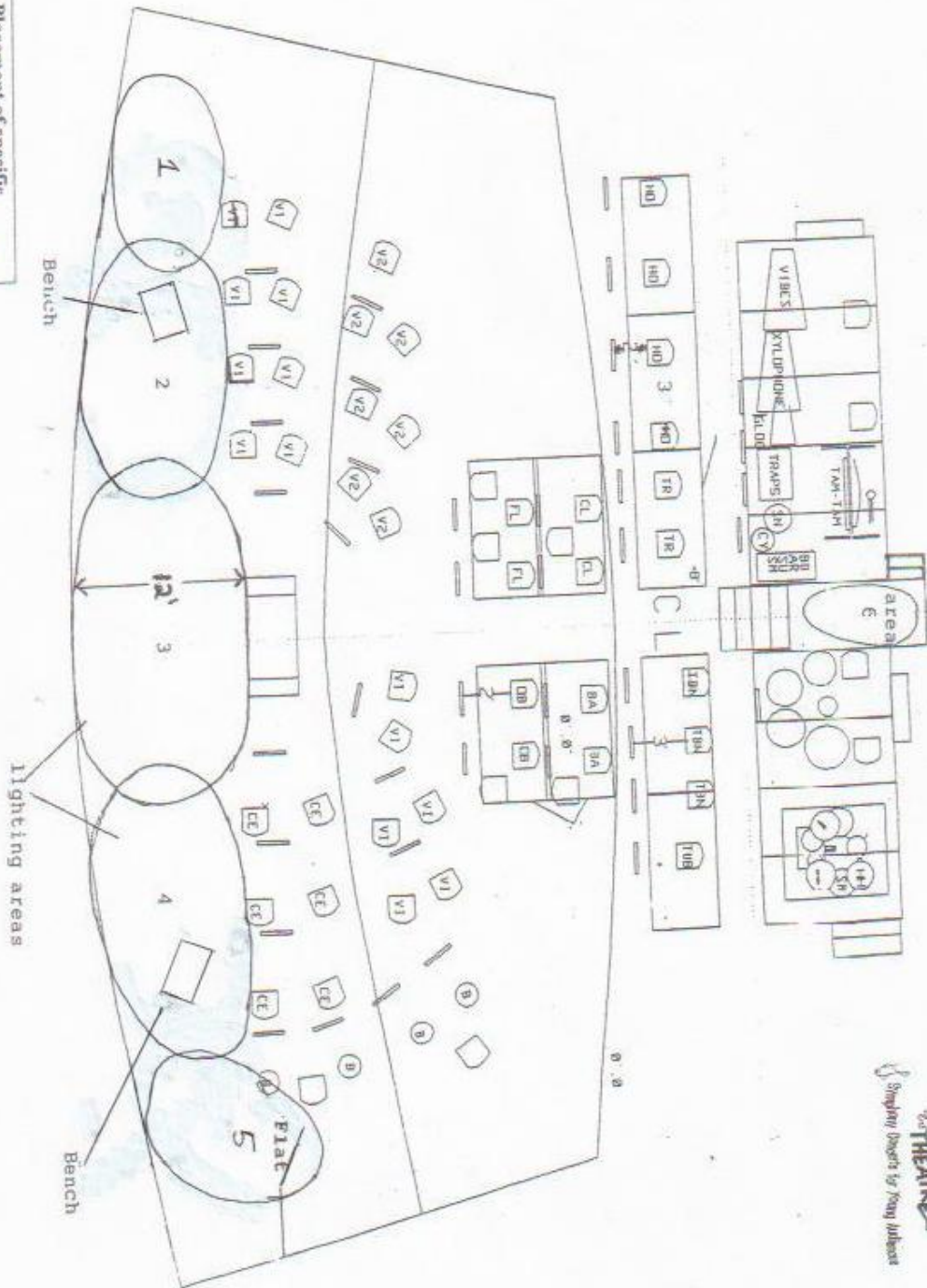

N.B. Placement of specific instruments is unimportant and is at the discretion of the orchestra